

Configuration Guide



Loudspeakers

DML500

8 Ohm High output distributed mode loudspeaker, large format carbon fiber acoustic panel with four high power exciter motor structures. Operates on bending wave physics principles providing excellent diffuse acoustic performance and high intelligibility in challenging architectural environments. Highly durable aluminum frame structure with multiple attachment points for ultimate flexibility and strength. Rugged physical construction features a powder coated die cast aluminum enclosure with multiple mounting points with a flexible mounting bracket with standard VESA attachment points.

DML500 BLK (Black Powder Coat)

DML500 WHT (White Powder Coat)



DML500A

8 Ohm High output distributed mode loudspeaker, large format carbon fiber acoustic panel with four high power exciter motor structures. The DML500R is an acoustic module which can be integrated into a variety physical structures. Operates on bending wave physics principles providing excellent diffuse acoustic performance and high intelligibility in challenging architectural environments. Rugged physical construction features a powder coated die cast aluminum frame with a variety of mounting and attachment points. Ships with an integrated mounting bracket with standard VESA attachment points. Product has no external frame or grille.



Subwoofers

LS212

4 Ohm Dual 12-inch subwoofer system, Features dual asymmetrical acoustic chambers delivering high sensitivity and output. Baltic birch plywood construction with black epoxy textured finish. Integrated M10 mounting points, heavy duty carry handles and M20, screw on pole mount attachment point. The LS212 can be implemented in a variety of different ways to provide high definition bass performance from a small footprint. FlatPanel Audio provides a variety of installation hardware and accessories to facilitate installation.



LS118

8 Ohm Single 18-inch subwoofer system, bass reflex design delivering high sensitivity and extended low frequency output. Baltic birch plywood construction with black epoxy textured finish. Integrated M10 mounting points, heavy duty carry handles and M20, screw on pole mount attachment point. The LS118 can easily be configured in dual and quad subwoofer arrays as needed for applications requiring increased bass output. FlatPanel Audio provides a variety of installation hardware and accessories to facilitate installation.



Accessories

FlatPanel Audio has a variety of accessories and hardware that allows installation of DML and Subwoofers. Please refer to the “Rigging and Installation Guidelines” manual for detailed information and safety recommendations.

Flyware Head

Hang DML using the Flyware Head and a pair of DML500 Flyware Bars.

Model: DFH

2 pieces each

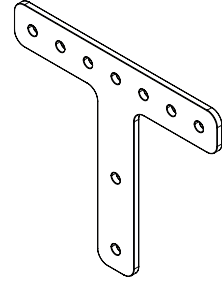

DML500 Flyware Bars

Flyware Bars attach to rear of the DML500 using M8 bolts. Allows DML500 to be hung and attached to a variety of accessories.

Model: DFB

2 pieces each

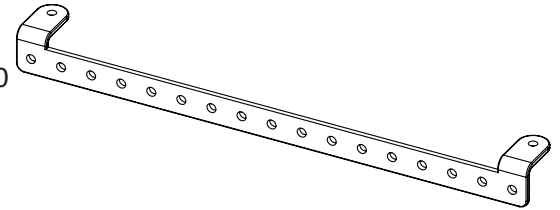

LS BAR

The LS BAR can be used to hang DML, Subwoofers, or combinations of both.

Model: LSB

2 pieces each

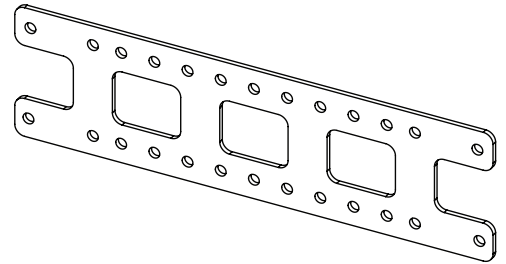

Connector Bar LS118

The Connector Bar LS118 kit attaches to the side of an LS118 subwoofer and connects two LS Bar accessories together.

Model: CB1

4 pieces each

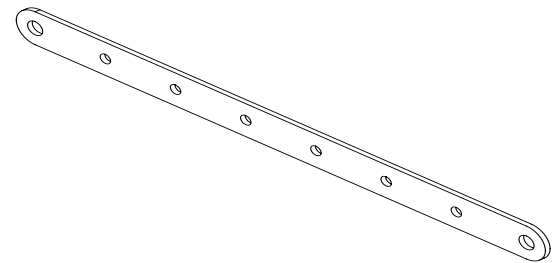

DML Hanger LS212

The DML Hanger LS212 bar bolts to an LS Bar and is used to hang an LS212 Subwoofer.

Model: HB2

2 pieces each

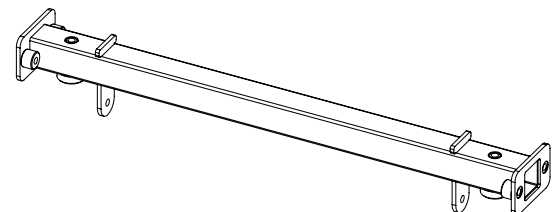

Connector Bar LS212

The Connector Bar LS212 kit attaches to the side of an LS212 subwoofer and connects two LS Bar accessories together.

Model: CB2

4 pieces each

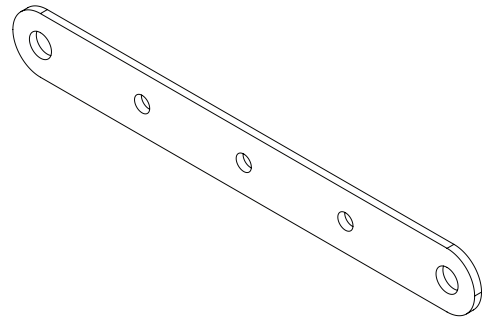

Pullback Element

A multi-purpose straight bar used for pull-back and attachment of other accessories.

Model: MPE

4 pieces each

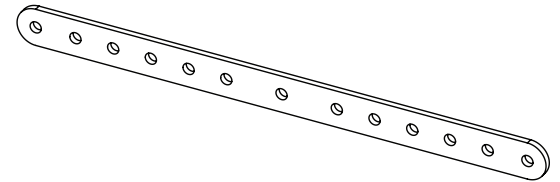

Vertical Pipe Mount

1.5-inch NPT Pipe thread to VESA (100x100) mount point. Attaches to the VESA bolt pattern found on all DML500 loudspeakers.

Model: VPM

1 piece each

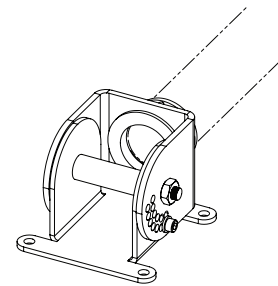

Pole Mount Adapter

VESA (100x100) mount point to standard speaker pole mount

Model: PMA

1 piece each

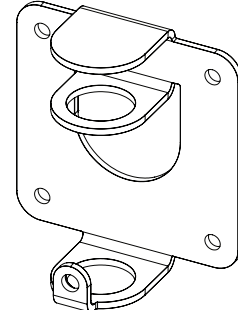

VESA Adapter Plate

VESA Adapter for 200 x 200

Model: VESA

1 piece each

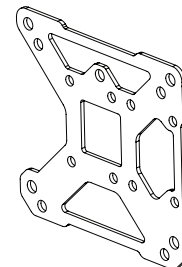

System Configurations

FlatPanel Audio has developed its loudspeakers and subwoofers to be deployed in a number of easy to integrate assemblies. System size depends on a number of factors including room dimensions, coverage objectives and application requirements.

System One

Nominal coverage: Horizontal/Vertical 165°

Max SPL: DML 120dB / LS212 130dB

Applications: Houses of worship, theaters, public address, casinos, buildings with complex architectural design elements

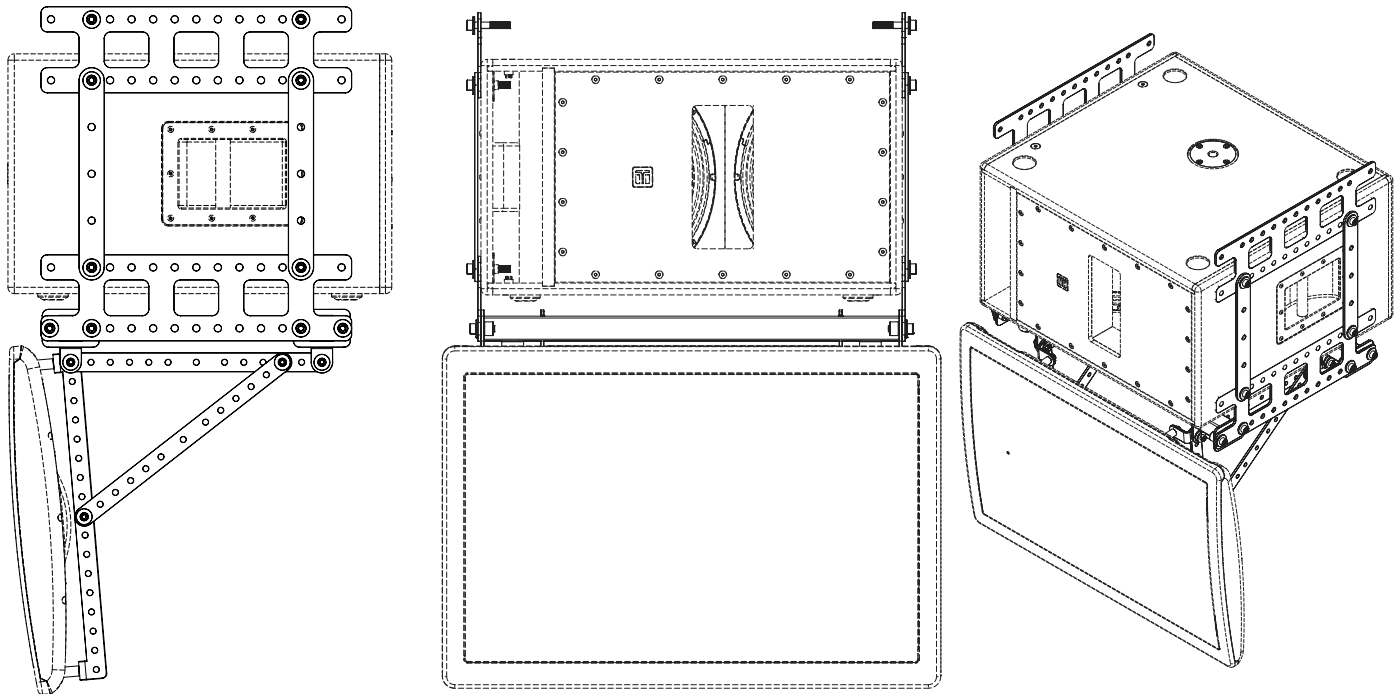

Quantity	Model Number	Description
1	DM500	DML500 Loudspeaker
2	LS212	LS212 Subwoofer
2 pieces	DFB	DML500 Flyware Bars
2 pieces	MPE	Pullback Element
2 pieces	HB2	DML Hanger Bar LS212
4 pieces	CB2	Connector Bar - LS212
4 pieces	LSB	LSBAR LS - Series Subwoofer Flyware Bar



System Two

Nominal coverage: Horizontal/Vertical 165°

Max SPL: DML 123dB / LS212 130dB

Applications: Houses of worship, theaters, public address, casinos, buildings with complex architectural design elements

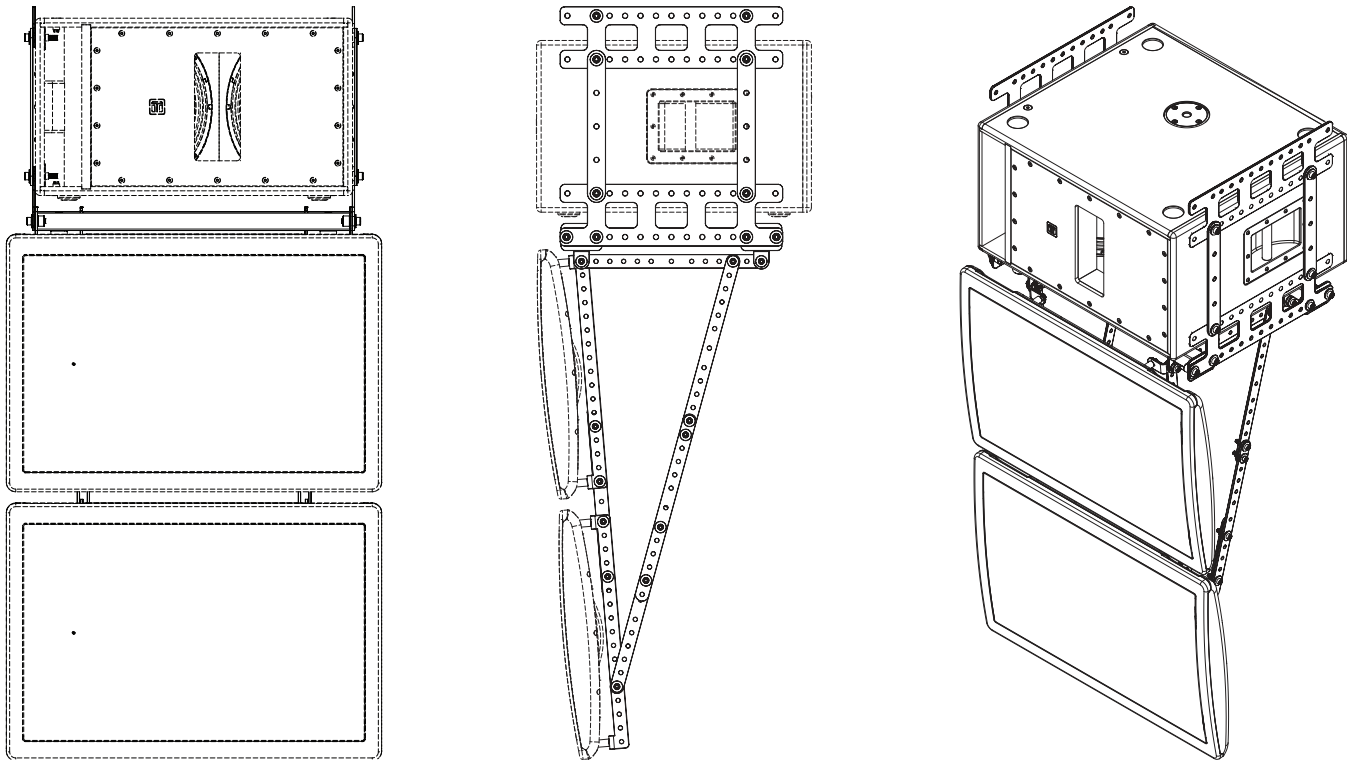

Quantity	Model Number	Description
2	DML500	DML500 Loudspeaker
1	LS212	LS212 Subwoofer
4 pieces	DFB	DML500 Flyware Bars
6 pieces	MPE	Pullback Elements
2 pieces	HB2	DML Hanger Bar LS212
4 pieces	CB2	Connector Bar LS212
4 pieces	LSB	LSBAR LS - Series Subwoofer Flyware Bar



System Three

Nominal coverage: Horizontal/Vertical 165°

Max SPL: DML 120dB / LS212 133dB

Applications: Houses of worship, theaters, public address, casinos, buildings with complex architectural design elements

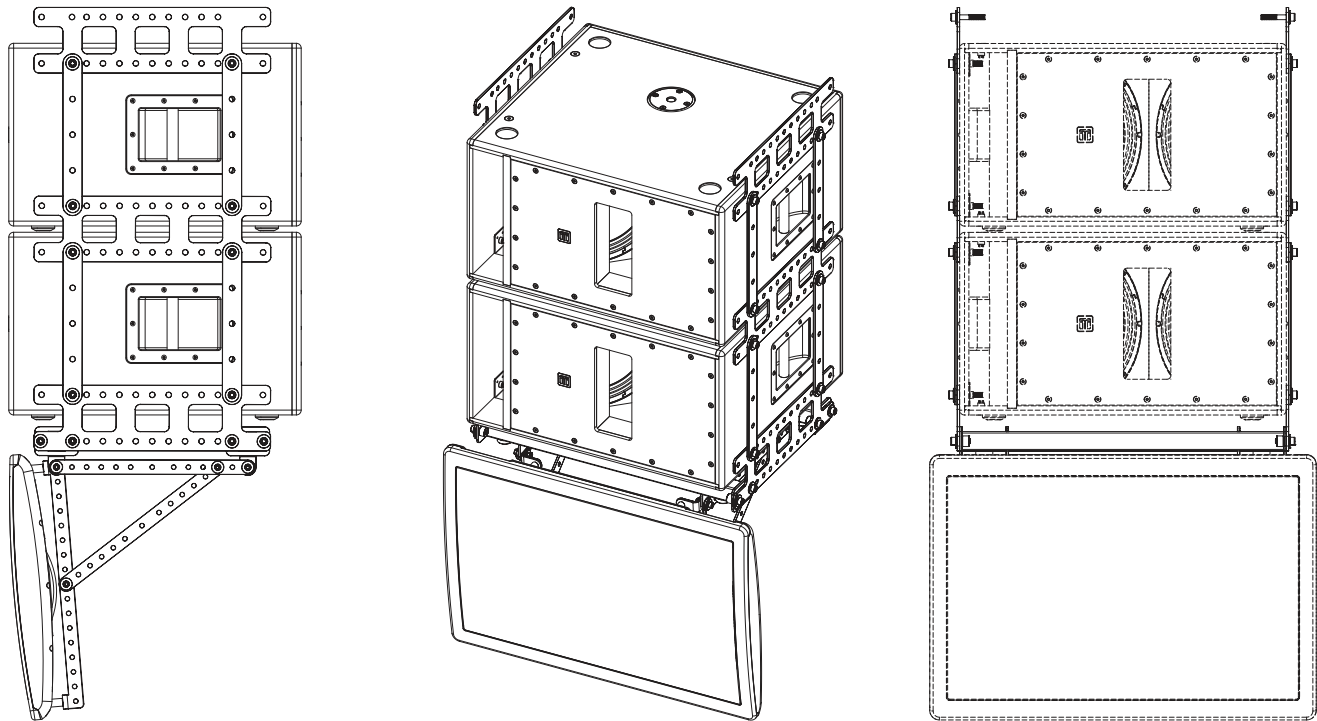

Quantity	Model	Description
1	DML500	DML500 Loudspeaker
1	LS212	LS212 Subwoofer
2 pieces	DFB	DML500 Flyware Bars
2 pieces	MPE	Pullback Element
2 pieces	HB2	DML Hanger Bar LS212
8 pieces	CB2	Connector Bar LS212
6 pieces	LSB	LSBAR LS - Series Subwoofer Flyware Bar



System Four

Nominal coverage: Horizontal/Vertical 165°

Max SPL: DML 123dB / LS212 133dB

Applications: Houses of worship, theaters, public address, casinos, buildings with complex architectural design elements

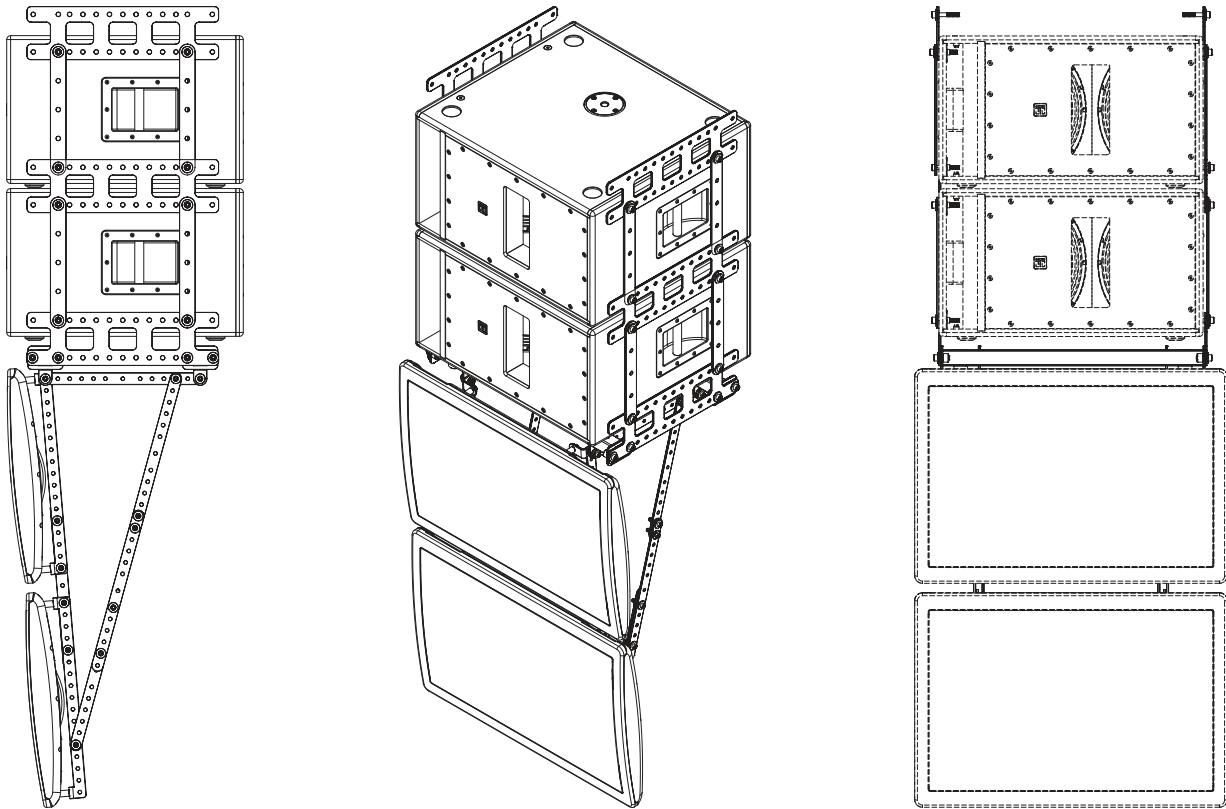

Quantity	Model	Description
2	DML 500	DML500 Loudspeaker
2	LS212	LS212 Subwoofer
4 pieces	DFB	DML500 Flyware Bars
10 pieces	MPE	Pullback Element
2 pieces	HB2	DML Hanger Bar LS212
8 pieces	CB2	Connector Bar LS212
6 pieces	LSB	LSBAR LS - Series Subwoofer Flyware Bar



System Five

Nominal coverage: Horizontal/Vertical 165°

Max SPL: DML 120dB / LS118 130dB

Applications: Houses of worship, theaters, public address, casinos, buildings with complex architectural design elements

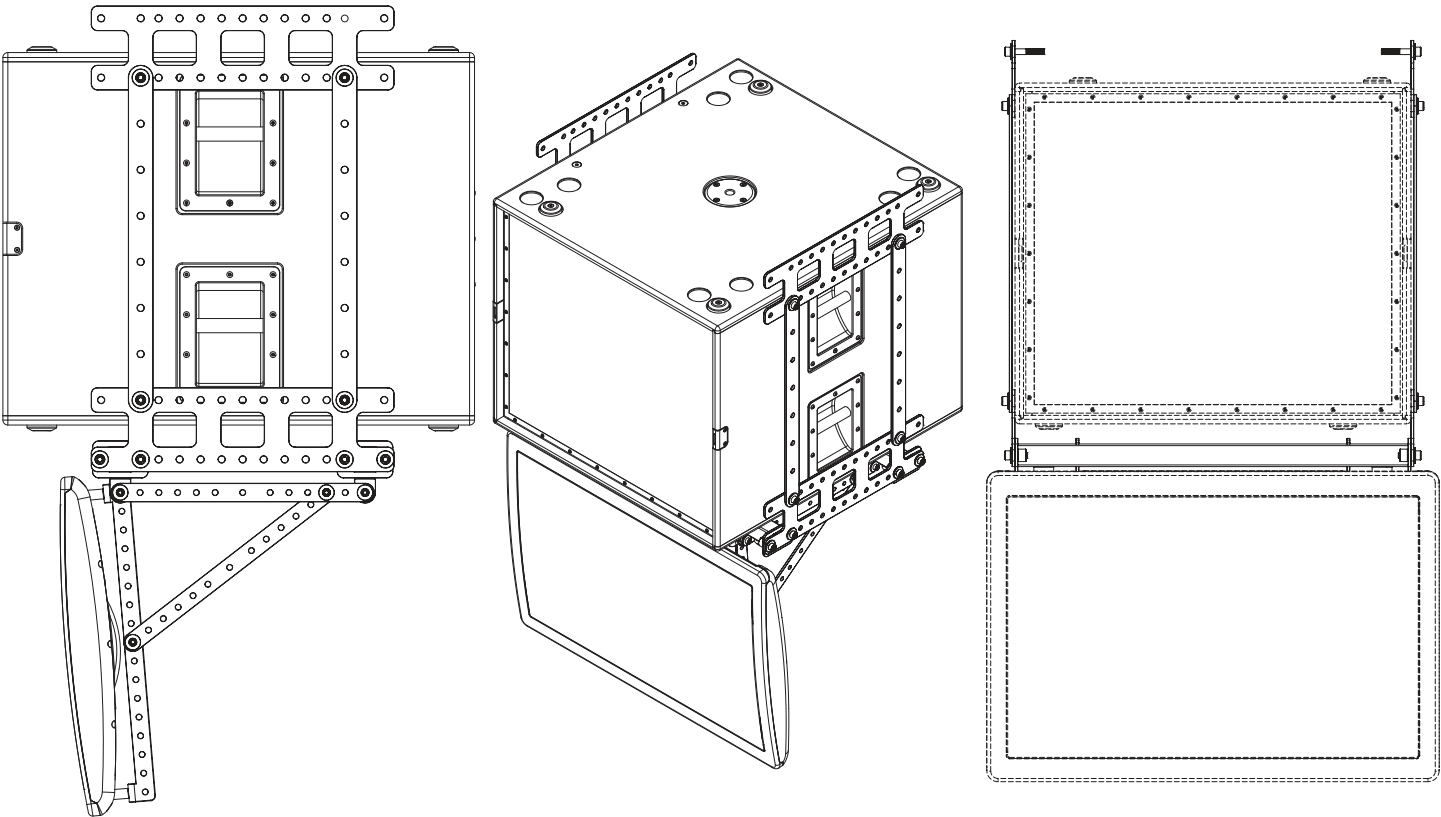

Quantity	Model Number	Description
1	DML 500	DML500 Loudspeaker
1	LS118	LS118 Subwoofer
2 pieces	DFB	DML500 Flyware Bars
2 pieces	MPE	Pullback Element
2 pieces	CB2	DML Hanger LS118
4 pieces	CB1	Connector Bar LS118
4 pieces	LSB	LSBAR LS - Series Subwoofer Flyware Bar



System Six

Nominal coverage: Horizontal/Vertical 165°

Max SPL: DML 123dB / LS118 130dB

Applications: Houses of worship, theaters, public address, casinos, buildings with complex architectural design elements

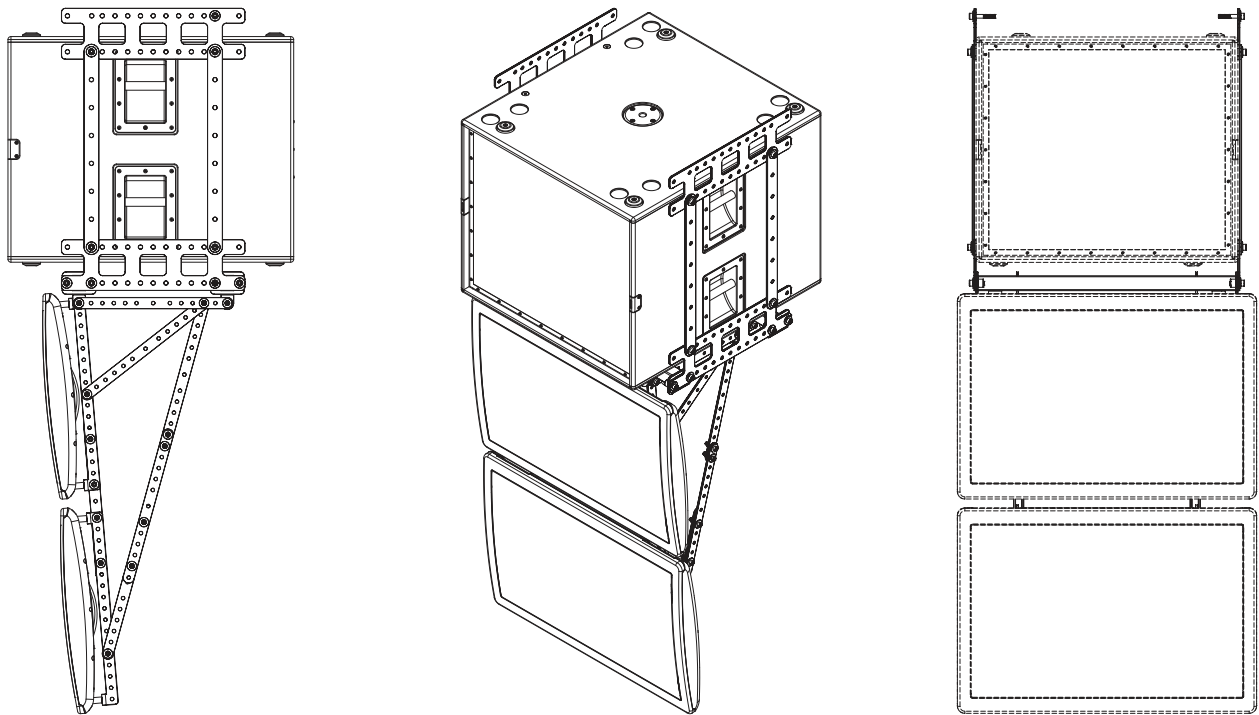

Quantity	Model Number	Description
2	DML 500	DML500 Loudspeaker
1	LS118	LS118 Subwoofer
4 pieces	DFB	DML500 Flyware Bar
6 pieces	MPE	Pullback Element
2 pieces	CB2	DML Hanger LS118
4 pieces	CB1	Connector Bar LS118
4 pieces	LSB	LSBAR LS - Series Subwoofer Flyware Bar



System Seven

Nominal coverage: Horizontal/Vertical 165 °

Max SPL: DML 123dB / LS118 133dB

Applications: Houses of worship, theaters, public address, casinos, buildings with complex architectural design elements

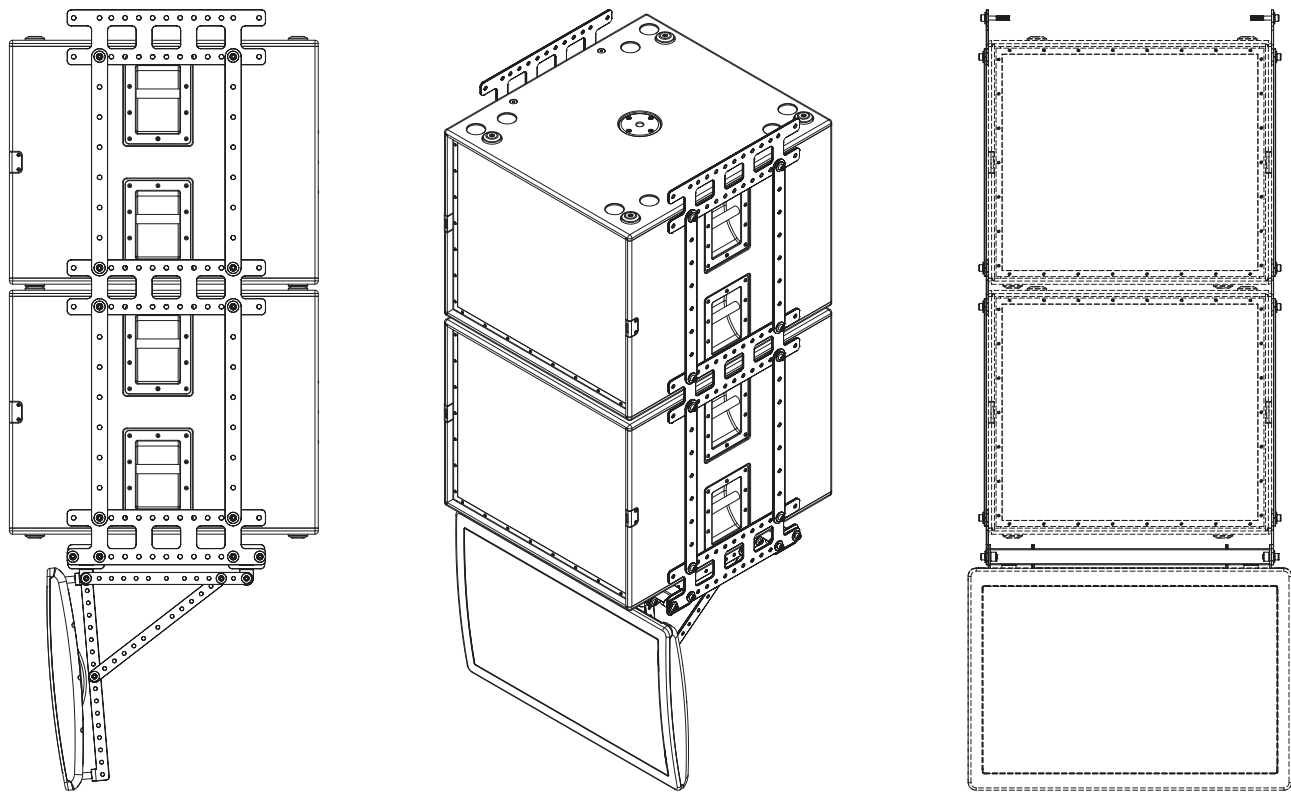

Quantity	Model Number	Description
1	DML 500	DML500 Loudspeaker
2	LS118	LS118 Subwoofer
2 pieces	DFB	DML500 Flyware Bars
2 pieces	MPE	Pullback Element
2 pieces	CB2	DML Hanger LS118
4 pieces	CB1	Connector Bar LS118
6 pieces	LSB	LSBAR LS - Series Subwoofer Flyware Bar



System Eight

Nominal coverage: Horizontal/Vertical 165°

Max SPL: DML 123dB / LS118 133dB

Applications: Houses of worship, theaters, public address, casinos, buildings with complex architectural design elements

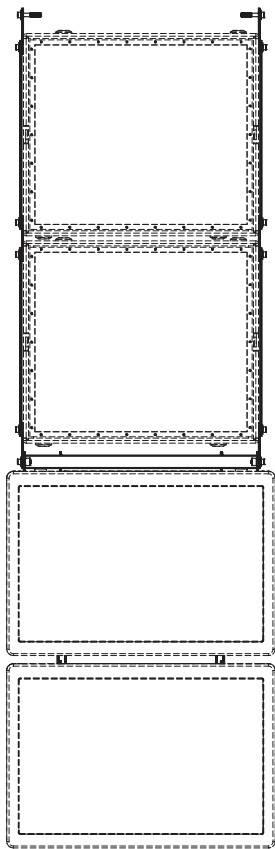
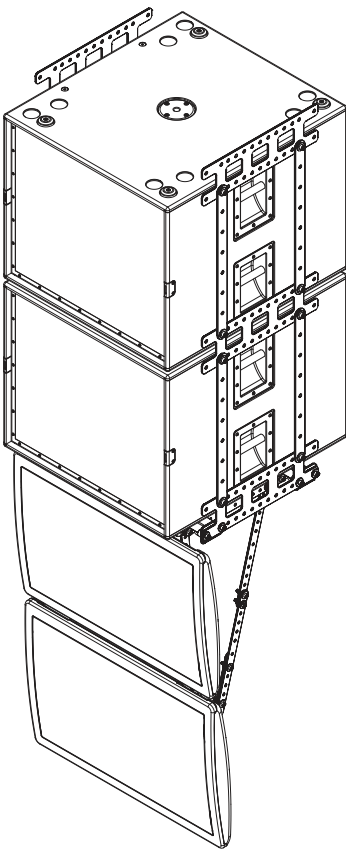
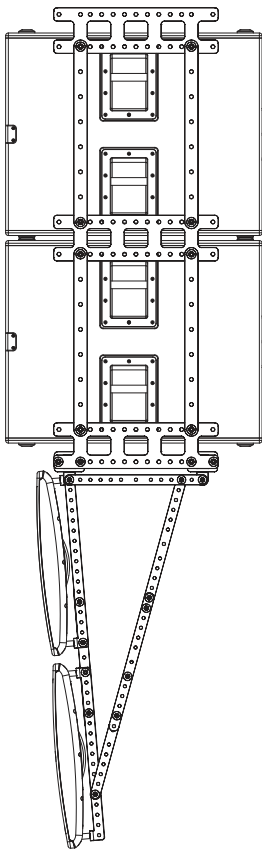

Quantity	Model Number	Description
2	DML500	DML500 Loudspeaker
2	LS118	LS118 Subwoofer
4 pieces	DFB	DML500 Flyware Bars
10 pieces	MPE	Pullback Element
2 pieces	CB2	DML Hanger - LS118
8 pieces	CB1	Connector Bar LS118
6 pieces	LSB	LSBAR LS - Series Subwoofer Flyware Bar



System Nine

Nominal coverage: Horizontal/Vertical 165°

Max SPL: DML 120dB

Applications: Houses of worship, theaters, public address, casinos, buildings with complex architectural design elements

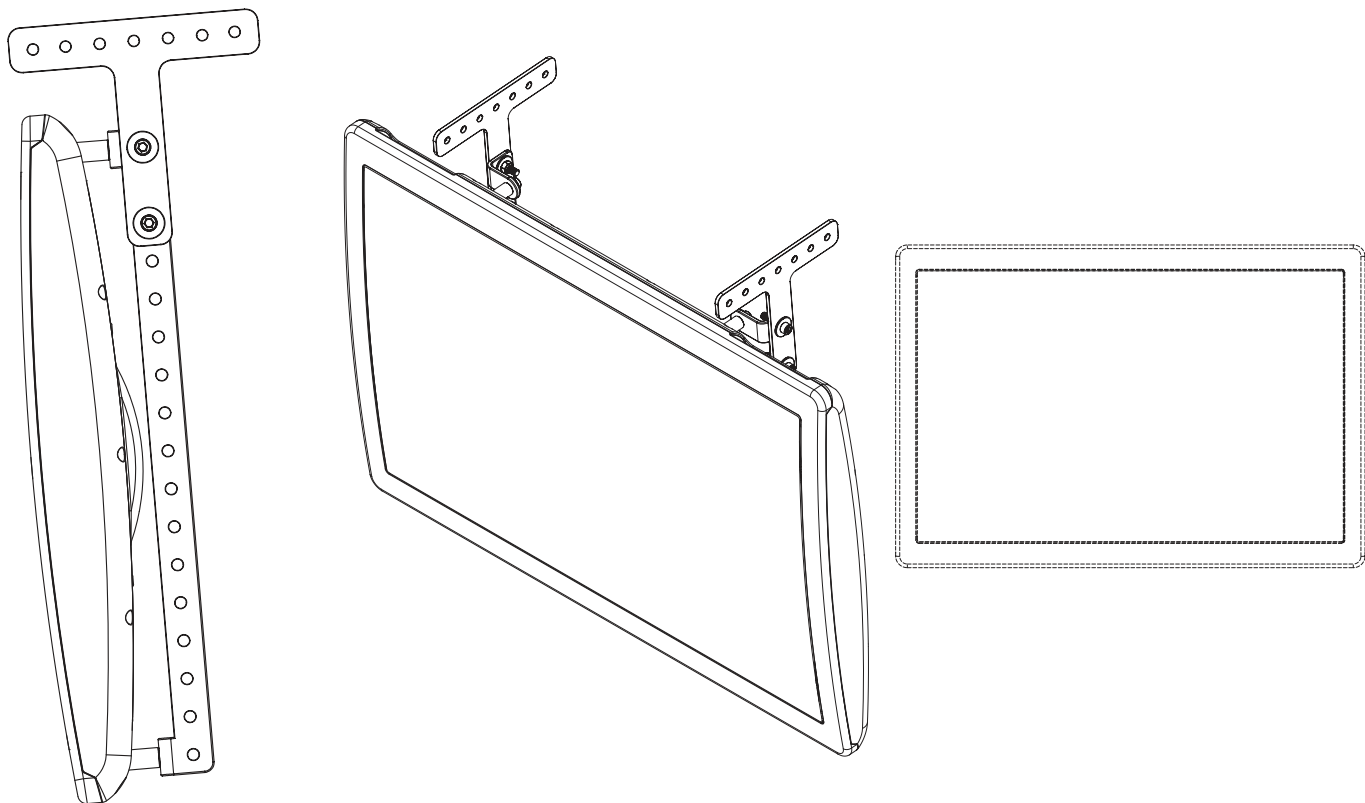

Quantity	Model Number	Description
1	DML500	DML500 Loudspeaker
2 pieces	DFB	DML500 Flyware Bars
2 pieces	DFH	DML500 Flyware Head



System Ten

Nominal coverage: Horizontal/Vertical 165°

Max SPL: DML 123dB

Applications: Houses of worship, theaters, public address, casinos, buildings with complex architectural design elements

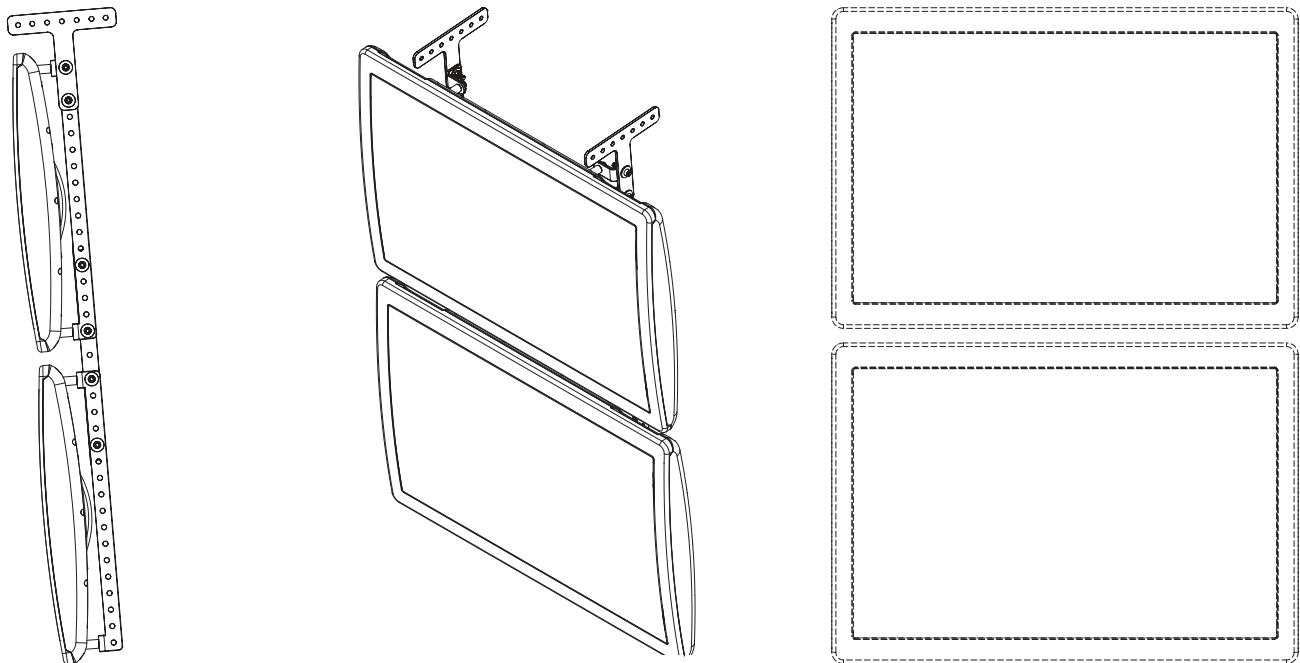

Quantity	Model Number	Description
2	DML500	DML500 Loudspeaker
4 pieces	DFB	DML500 Flyware Bars
2 pieces	DFH	DML500 Flyware Head
4 pieces	MPE	Pullback Element



System Eleven

Nominal coverage: Horizontal/Vertical 165°

Max SPL: DML 120dB

Applications: Houses of worship, theaters, public address, casinos, buildings with complex architectural design elements

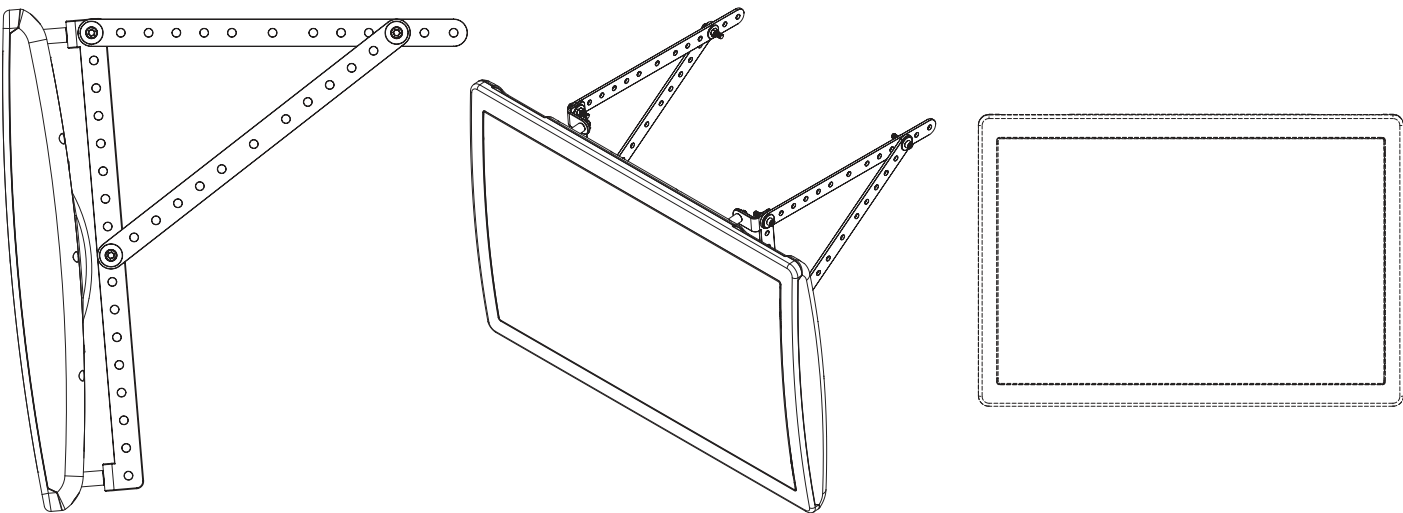

Quantity	Model Number	Description
1	DML500	DML500 Loudspeaker
2 pieces	DFB	DML500 Flyware Bars
4 pieces	MPE	Pullback Element



System Twelve

Nominal coverage: Horizontal/Vertical 165°

Max SPL: DML 120dB

Applications: Houses of worship, theaters, public address, casinos, buildings with complex architectural design elements

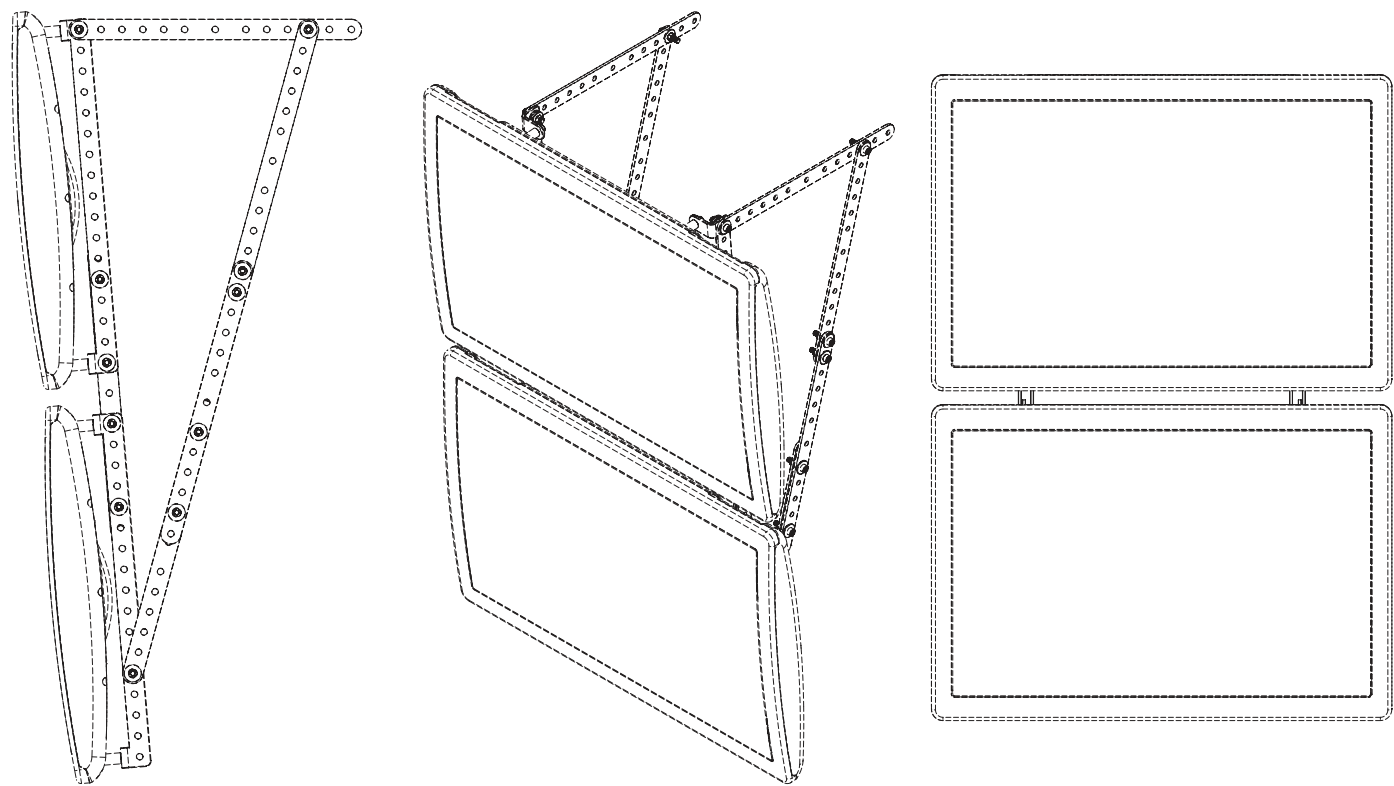

Quantity	Model Number	Description
2	DML500	DML500 Loudspeaker
4 pieces	DFB	DML500 Flyware Bars
12 pieces	MPE	Pullback Element

